

Floral Painting

Designed by Diane Nagel

Featuring Whistler Studio's *Finger Painted Florals Collection*

SIZE: 60" x 60"



Also available in pink/yellow version!



PLEASE NOTE: QUILT IMAGE SHOWN IS A DIGITAL REPRESENTATION, FABRIC LOOK MAY VARY ON YOUR PROJECT.
VISIT OUR [FREE PROJECT](#) SECTION ONLINE FOR ANY PATTERN UPDATES BEFORE STARTING QUILT PROJECT.



WINDHAM FABRICS

Floral Painting

Page 2



Finished Blocks: 15" x 15"

Materials:

	Blue-Green quilt	Pink-yellow quilt	Amount	Used for
Fabric A	37098-12 Chalk	37098-12 Chalk	1 1/4 yards-- 2 yds for pink quilt	Background and border
Fabric B	40751-2 Blue	37098-14 Duckling	1/8 yard	blocks
Fabric C	37098-34 Spruce	37098-24 Pink	5/8 yard	Blocks, border 2
Fabric D	40750-2 Blue	40750-3 Purple	1 yard--1/4 yard for pink quilt	Blocks, border
Fabric E	40749-2 Blue	40749-1 Pink	1/2 yard--1 1/4 yards for pink quilt	Blocks/ border for pink
Fabric F	40751-4 Grey	40751-4 Grey	1/2 yard	Blocks
Fabric G	40750-4 Grey	Not used	1 yard—not used for pink quilt	Blocks
Fabric H	40750-5 Green	40750-1 Pink	1/2 yard	Blocks
Fabric I	37098-33 Ocean	37098-25 Grape	1/2 yard	Binding

Note: The cutting directions will be for both the blue-green and pink-yellow quilt, unless otherwise stated. Any additional cutting for the pink-yellow quilt version will be added in at the end of each fabric, noting the color version.

Floral Painting

Page 3

Cutting:

From Fabric A, cut:

- (4) 1 ½" x 42" strips. Piece the strips and cut into (2) 1 ½" x 45 ½" strips and cut (2) 1 ½" x 47 ½" strips for inner border.
- (3) 3 7/8" x 42" strips; cut into (30) 3 7/8" squares, cut once on diagonal for Varied Goose block.
- (2) 3 ½" x 42" strips; cut into (20) 3 ½" squares for Varied Goose block.
- (3) 1 ½" x 42" strips; cut into (60) 1 ½" squares for Varied Goose block.
- (1) 1 ½" x 42" strip; cut into (20) 1 ½" x 3 ½" rectangles for Varied Goose block.
- (3) 2 ½" x 42" strips; cut into (44) 2 ½" squares for outer border.

For Pink-yellow quilt only add:

- (1) 3 7/8" x 42" strip; cut into (8) 3 7/8" squares, cut once on diagonal for Churn Dash block.
- (1) 9 ½" x 42" strip; cut into (16) 2" x 9 ½" rectangles for Churn Dash block.
- (1) 11 ¼" x 42" strip; cut into (5) 11 ¼" squares, cut twice on diagonal for outer border. Save remaining strip.
- Using remaining 11 ¼" strip, trim down to 5 7/8". Cut (2) 5 7/8" squares, cut once on diagonal for outer border
-

From Fabric B, cut:

- (2) 1 ½" x 42" strips; cut into (40) 1 ½" squares for Varied Goose block.

From Fabric C, cut:

- (3) 1 ½" x 42" strips; cut into (60) 1 ½" squares for Varied Goose block.
- (1) 1 ½" x 42" strip; cut into (2) 1 ½" x 3 ½" rectangles for Varied Goose block.
- (5) 2" x 42" strips. Piece the strips and cut (2) 2" x 47 ½" strips and cut (2) 2" x 50 ½" strips for border 2

From Fabric D, cut:

- (1) 1 ½" x 42" strip; cut into (20) 1 ½" squares for Varied Goose block.
- (1) 3 ½" x 42" strip; cut into (20) 1 ½" x 3 ½" rectangles for Varied Goose block.

For Blue-Green version only add:

- (4) 5 7/8" x 42" strips; cut into (22) 5 7/8" squares, cut once on diagonal for outer border.

From Fabric E, cut:

- (1) 3 ½" x 42" strip; cut into (5) 3 ½" squares for Varied Goose block.
- (1) 9 ½" x 42" strip; cut into (4) 9 ½" squares for Churn Dash block.

For Pink-Yellow quilt only add:

- (4) 5 7/8" x 42" strips; cut into (22) 5 7/8" squares, cut once on diagonal for outer border.

Floral Painting

Page 4

For Fabric F, cut:

- (3) 3 7/8" x 42" strips; cut into (30) 3 7/8" squares, cut once on diagonal for Varied Goose block.

For Fabric G, cut:

All cutting is for the Blue-Green quilt only:

- (1) 3 7/8" x 42" strip; cut into (8) 3 7/8" squares, cut once on diagonal for Churn Dash block.
- (1) 9 1/2" x 42" strip; cut into (16) 2" x 9 1/2" rectangles for Churn Dash block.
- (1) 11 1/4" x 42" strip; cut into (5) 11 1/4" squares, cut twice on diagonal for outer border. Save remaining strip.
- Using remaining 11 1/4" strip, trim down to 5 7/8". Cut (2) 5 7/8" squares, cut once on diagonal for outer border

For Fabric H, cut:



- (1) 3 7/8" x 42" strip; cut into (8) 3 7/8" squares, cut once on diagonal for Churn Dash block.
- (1) 9 1/2" x 42" strip; cut into (16) 2" x 9 1/2" rectangles for Churn Dash block.

For Fabric I, cut:

- (6) 2 1/2" x 42" binding strips.





Block Assembly

Varied Goose block:

1. Sew a Fabric A and F 3 7/8" triangle together to make a half square triangle (HST) → 
Make 12.
2. Sew together (2) HSTs as shown →  Sew to the left side of a Fabric A 3 1/2" square.
3. Sew together (2) HSTs in the reverse position as shown →  Sew to the right side of the 3 1/2" square to complete row 1 of the block. Make 2.



← Row 1. Make 2.

4. Sew a Fabric A and B 1 1/2" square together →  +  Add a Fabric A 1 1/2" square to the right end of the unit to make row A.
5. Sew a Fabric B 1 1/2" square to the left side of (2) Fabric C squares to make row B → 
6. Sew a Fabric A 1 1/2" square to the left side of a Fabric C square, and a Fabric D 1 1/2" square to the right end of the unit to make row C → 
7. Sew the rows A to the top of row B, sew row C to the bottom of row B to complete the 9 patch unit. Make 4 units. Set aside.



← 9 patch unit. Make 4

Floral Painting

Page 5

8. Sew a Fabric A $1\frac{1}{2}$ " x $3\frac{1}{2}$ " rectangle to a matching Fabric C rectangle, long sides together. Sew a Fabric D $1\frac{1}{2}$ " x $3\frac{1}{2}$ " rectangle to the bottom of the strip unit.

Make 4. Set aside.

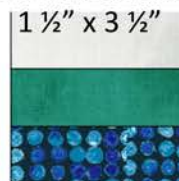

← Strip unit. Make 4.

9. Working from left to right, and referring to the diagram below for rotation of the units, sew a horizontal row starting with a HST, 9 patch unit, strip unit, 9 patch unit and a HST as shown to complete row 2 of the block. Make 2.



← Row 2. Make 2.

10. Working from left to right sew a Fabric A $3\frac{1}{2}$ " square, a Strip unit, a Fabric E $3\frac{1}{2}$ " square, and Strip unit, and a Fabric A $3\frac{1}{2}$ " square as shown to complete Row 3. Make 1.



← Row 3. Make 1.

11. Sew Row 1 from Step 3 to the top of Row 2 (Step 9). Sew Row 3 (Step 10) to the bottom of Row 2.

12. Rotate the second Row 2 and sew to the bottom of Row 3.

13. Rotate the second Row 1 and sew to the bottom of the block as shown. Make 5 blocks. Set aside.



← Varied Goose block.
Make 5.

Churn Dash block: Note: for the Pink-Yellow version only, all Fabrics G in the instructions will be Fabric A.

1. Sew a Fabric H and G 2 " x $9\frac{1}{2}$ " rectangle together on long sides. Make 4 →

2. Sew together a Fabric H and G $3\frac{7}{8}$ " triangle together to make a HST.

Make 4.



← HST

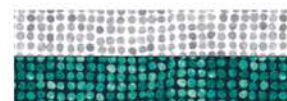

3. Sew a HST to both ends of the rectangle unit in Step 1 as shown →
Make 2.



Floral Painting

Page 6

4. Sew a rectangle unit from Step 1 to both sides of a Fabric E 9 1/2" square as shown ↓
5. Sew the unit in Step 3 to the top of the unit in Step 4.
6. Rotate the second unit from Step 3 and sew to the bottom of the block. Repeat to make 4 blocks.

Churn Dash block →
Make 4.



Quilt Center Assembly

1. The quilt center will be sewn in 3 horizontal rows of 3 blocks each. Sew each row as stated from left to right as follows:
2. Row 1: Varied Goose block, Churn Dash block, Varied Goose block.
3. Row 2: Churn Dash block, Varied Goose block, Churn Dash block.
4. Row 3: Varied Goose block, Churn Dash block, Varied Goose block.
5. Sew the rows 1-3 together horizontally working from top to bottom, to complete the quilt center.

Row 1 →



Row 2 →

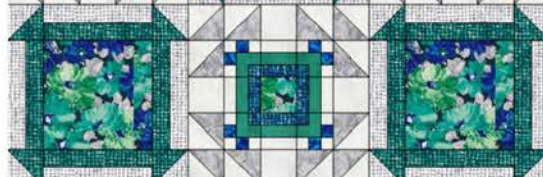

Row 3 →



Borders:

1. Sew the Fabric A 1 1/2" x 45 1/2" strips to the sides of the quilt center. Sew the Fabric A 1 1/2" x 47 1/2" strips to the top and bottom of the quilt.
2. Sew the Fabric C 2" x 47 1/2" strips to the sides of the quilt. Sew the Fabric C 2" x 50 1/2" strips to the top and bottom of the quilt.

Floral Painting

Page 7

Outer Border:

1. Sew a Fabric D and G $5 \frac{7}{8}$ " triangle together to make a HST. Make 4. *Note: the Pink-Yellow version will be sewn using Fabrics E instead of D. Use Fabric A instead of G.*
2. Draw a diagonal pencil line on the wrong side of a Fabric A $2 \frac{1}{2}$ " square. Lay the square, right sides together on the Fabric D corner, lining up raw edges of the HST unit. Stitch on the drawn line, trim $\frac{1}{4}$ " seam allowance and press to the corner. Repeat to make 4 Corner units as shown →
3. Sew the long side of a Fabric D $5 \frac{7}{8}$ " triangle to both short sides of a Fabric G $11 \frac{1}{4}$ " quarter square triangle to make a flying geese unit.

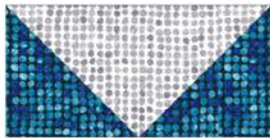

←flying geese unit.

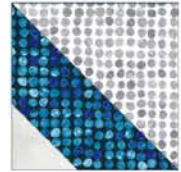

4. Repeating the instructions in Step 2, sew a Fabric A $2 \frac{1}{2}$ " square along the diagonal line to both Fabric D corners of the flying geese unit in Step 3. Trim to $\frac{1}{4}$ " seam allowance and press to the corners to complete the unit. Make 20.

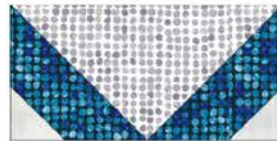

←Completed flying geese unit.

5. Sew (5) completed flying geese units together end to end as shown. Make 4 rows.

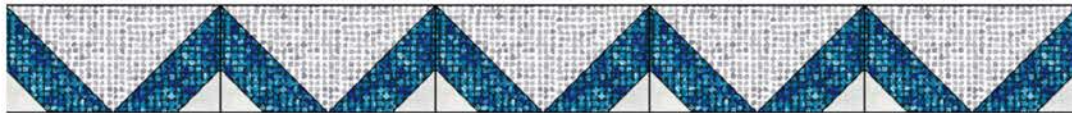

6. Rotate and sew a flying geese row from Step 5 to both sides of the quilt, with the points outward.
7. Sew a completed corner unit from Step 2 to both ends of the remaining two flying geese rows, making sure the Fabric A corners face the same side as shown. Sew to the top and bottom of the quilt.

Corner Unit ↓



8. Layer quilt, quilt as desired and bind using the Fabric I $2 \frac{1}{2}$ " binding strips.

